

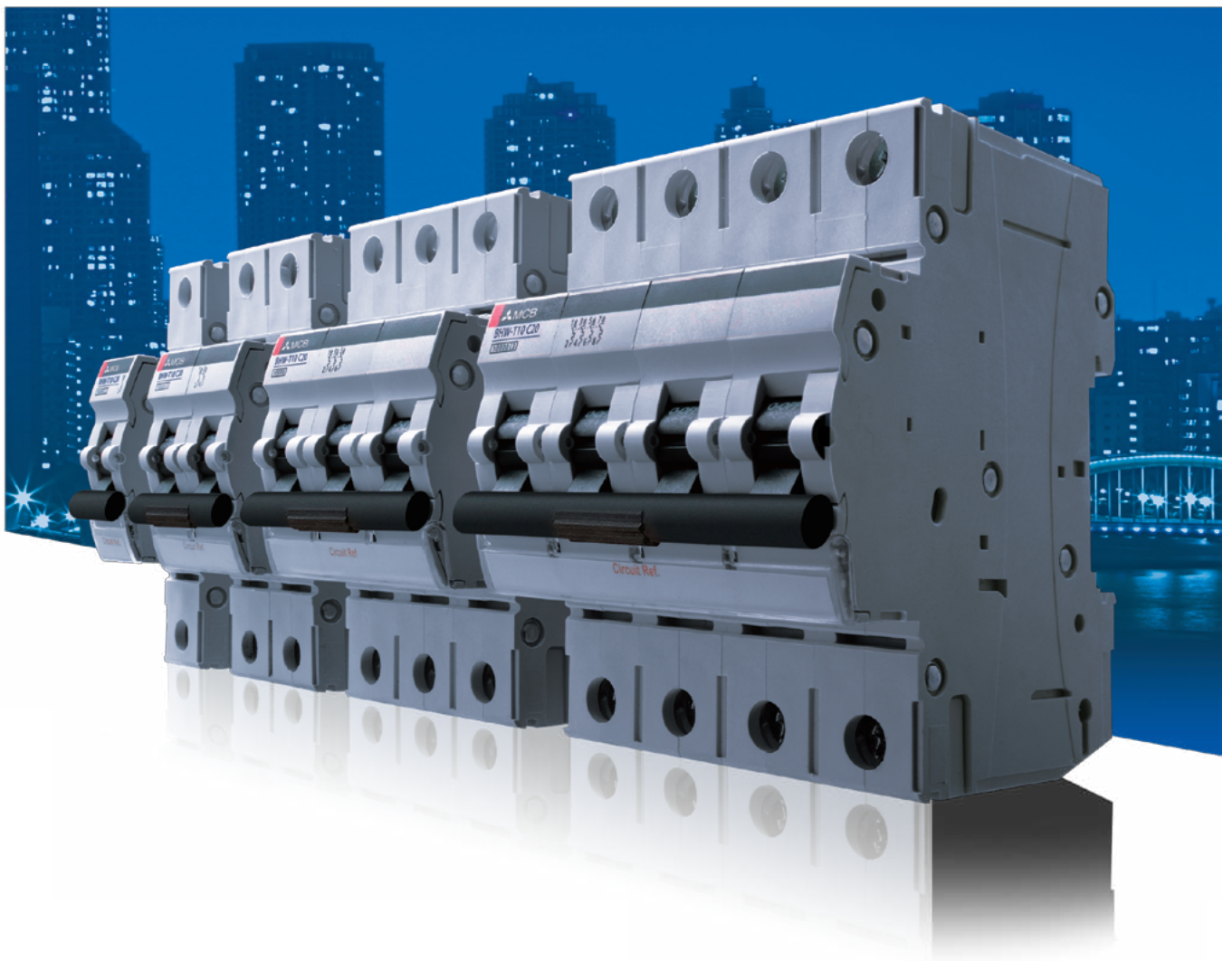

for a greener tomorrow

FACTORY AUTOMATION

# Miniature Circuit Breakers Residual Current Circuit Breakers Isolating Switches **DIN Series**





*Breaking Through The*

## Introducing the DIN Series...

High-quality, high-performance circuit breakers suitable for household electrical distribution panels

# DIN Series

## INDEX

● <b>Features and Product Line-up and Points to Note</b> .....	<b>3</b>
Features and Product Line-up.....	3
Points to Note .....	4
● <b>Specifications</b> .....	<b>5</b>
Miniature Circuit Breakers (MCB).....	7
Residual Current Circuit Breakers (RCCB) .....	11
Isolating Switches .....	12
● <b>Ordering Information</b> .....	<b>13</b>



## Features

- (1) All models fully comply with IEC regulations
- (2) Compliance with IP2X protection rating (front surface)
- (3) All models are compatible with reverse connection
- (4) Rated currents up to 125A for MCB, 100A for RCCB
- (5) Accessories suitable for field fitted for MCB (80 to 125A)

## Product Line-up

Model		No of poles (P)	Rating	Instantaneous tripping	Voltage (V)	Short-Circuit capacity (kA)	Compliance standard
MCB	BHW-T10	1, 1+N, 2, 3, 3+N, 4	6 to 63A	TYPE B	240/415AC	10	IEC 60898-1
		1, 1+N, 2, 3, 3+N, 4	0.5 to 63A	TYPE C, D	240/415AC		IEC 60898-1
		1, 2, 3, 4	80 to 125A	TYPE B, C	240/415AC	10	IEC 60898-1 IEC 60947-2
RCCB	BVW-T	2(1+N), 4(3+N)	16 to 100A	—	240/415AC	—	IEC 61008-1
Isolating Switches	KBW-T	1, 2, 3, 4	25 to 63A	—	240/415AC	—	IEC 60947-3
		2, 3, 4	80 to 125A	—	240/415AC	—	IEC 60947-3

## Explanation of Markings (Example Model : BHW-T10)

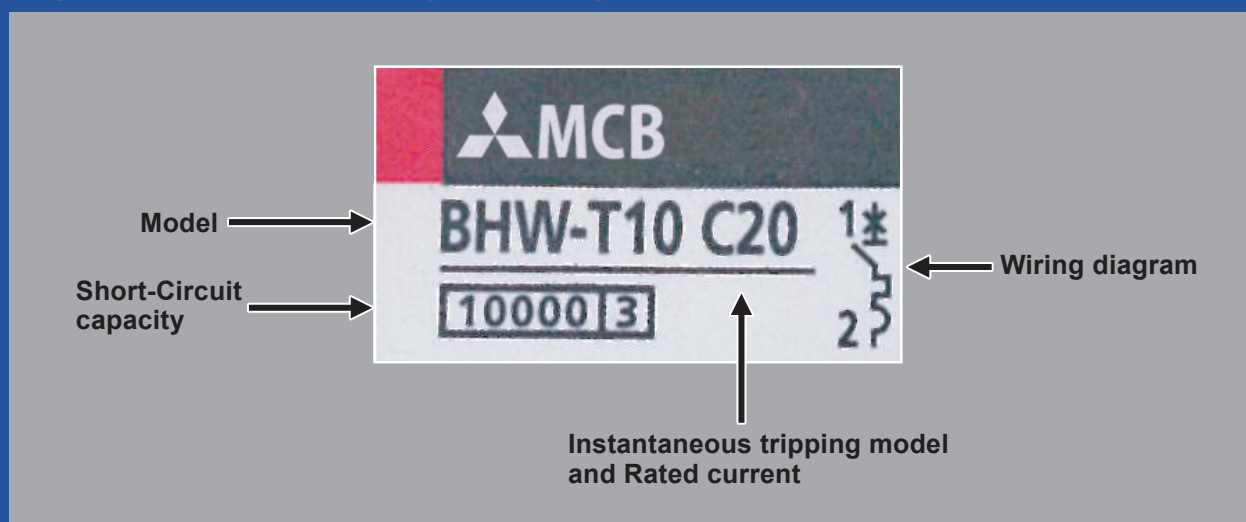

## Technical Specifications

Ambient temperature range	-10 to +40°C
Frequency	50/60Hz





## Points to Note

### 1 Installation

Standard IEC 35mm rail installation is possible.  
Fix by attaching a slip stopper.

Fig-1

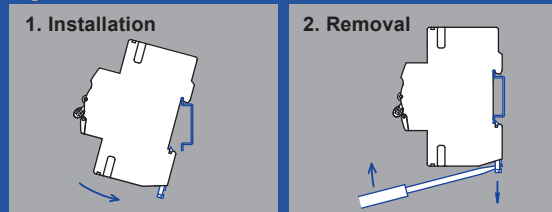

### 2 Connection

At the time of wire connection, fasten the terminal screws with the torque stated in the table below.

Fastening torque

Screw diameter	Fastening torque (N·m)	Model
M3	0.5	AL(80 to 125A), AX(80 to 125A), SHT(80 to 125A)
M5	2.0	BHW-T10(0.5 to 63A), BVW-T, KBW-T(25 to 63A), SHT (0.5 to 63A)
M6	2.5	KBW-T(80 to 125A)
M8	3.5	BHW-T10(80 to 125A)

### 3 Opening, Closing and Tripping Operations

Move the handle up/down to turn power On/Off. Tripping operation refers to automatic opening (breaking) of circuits.

### 4 Earth-leakage Test

#### Earth-leakage test steps:

- (1) Move the handle to the On position under rated voltage.
  - (2) Push the yellow test button.
  - (3) At this time, the RCCB must be tripped within the specified time.
  - (4) The handle will move to the Off position.
- \* Please conduct the above test regularly.  
\* Do not use the test button to switch off the RCCB.

### 5 Cleaning

Never use thinner, detergent, and other chemicals for cleaning.  
It is likely to make letters on the plate illegible or to lower insulation performance.  
Clean the breaker using air cleaner or by brushing.

### 6 Selection

In case of installing MCB side by side, reduce the passing current to under 80% of the rated current.  
Set current rating with enough allowance while taking fluctuation of power voltage and load current into consideration.

### 7 Connection with solderless terminal

Crimp after loosening strand of the connection wire and putting the core wires together.  
Regular inspection and retightening are necessary as the wires come loose as time goes.

### 8 Installation

When a metal panel comes close to MCB (80 to 125A), be sure to secure a distance of more than 5mm in between.

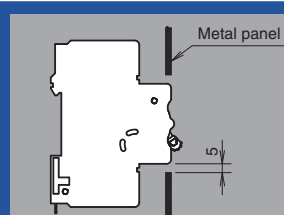

## Specifications

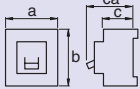
Model		MCB													
Image															
No. of poles [P]		1	1+N <sup>*1</sup>	2	3	3+N <sup>*1</sup>	4	1	1+N <sup>*1</sup>	2	3	3+N <sup>*1</sup>	4		
Instantaneous tripping <sup>*2</sup>		Type B						Type C, D							
Rated insulation voltage <i>U<sub>i</sub></i> [V]		660						660							
Rated current <i>I<sub>n</sub></i> [A] at ambient temperature 30°C		6, 10, 16, 20, 25, 32, 40, 50, 63						0.5, 1, 2, 3, 4, 5, 6, 10, 16, 20, 25, 32, 40, 50, 63							
Rated short-circuit capacity [kA]	IEC/EN 60898-1 (I <sub>cn</sub> )	AC	240V	10						10					
			240/415V	10	–	10		10	–	10					
			415V	–		10		–		10					
Energy limiting class <sup>*3</sup>		Class 3													
Number of operating cycles		Without current		4,000											
		With current		4,000											
		a	18	36		54	72		18	36		54	72		
		b	92.6												
		c	44												
		ca	Max. 73.5												
Type of overcurrent release		Thermal-magnetic													
Mounting		IEC 35mm rail													
Applicable wire size [mm <sup>2</sup> ]		1 to 25													
Mass [kg]		0.13	0.25	0.26	0.39	0.51	0.52	0.13	0.25	0.26	0.39	0.51	0.52		
Accessories (optional) <sup>*4</sup>		Auxiliary switch (AX)		<input type="radio"/>											
		Shunt trip (SHT)		<input type="radio"/>											
Terminal connection		Solderless terminal													
Based on standard		IEC/EN 60898-1													
CE marking		<input type="radio"/>													

\*1: N pole is a switched neutral pole (without overcurrent release device).

\*2: Type B (3  $I_n < \leq 5 I_n$ ), Type C (5  $I_n < \leq 10 I_n$ ), Type D (10  $I_n < \leq 20 I_n$ )

\*3: Except for Type D

\*4: Factory fitted

\*5: In case of installing breakers side by side, reduce the passing current to under 80% of the rated current.

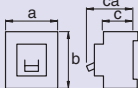
				MCB				
Model				BHW-T10				
Image								
No. of poles [P]				1	2	3	4	
Instantaneous tripping <sup>*1</sup>				Type B, C				
Rated insulation voltage $U_i$ [V]				690				
Rated current $I_n$ [A]	Amb. temp.	IEC/EN 60898-1	30°C	80, 100, 125				
		IEC/EN 60947-2	40°C					
Rated short-circuit capacity [kA]	IEC/EN 60898-1 (Icn)	AC	240/415V	10				
	IEC/EN 60947-2 (Icu/Ics)	AC	240/415V	10/7.5				
Rated impulse withstand voltage $U_{imp}$ [kV]				6				
Suitability for isolation				Compatible				
Utilization category				A				
Pollution degree				3				
Number of operating cycles		Without current		10,000				
		With current		4,000				
			a	27	54	81	108	
			b	94				
			c	44				
			ca	74.5				
			Type of overcurrent release				Thermal-magnetic	
Mounting				IEC 35mm rail				
Applicable wire size [mm²]				10 to 50				
Mass [kg]				0.21	0.42	0.63	0.84	
Accessories (optional) <sup>*2</sup>		Alarm switch (AL)		○ <sup>*4</sup>				
		Auxiliary switch (AX)		○				
		Shunt trip (SHT)		○ <sup>*4</sup>				
Terminal connection				Solderless terminal				
Based on standard				IEC/EN 60898-1 <sup>*5</sup> , IEC/EN 60947-2				
CE marking				○				

\*1: Type B (3  $I_n < \leq 5 I_n$ ), Type C (5  $I_n < \leq 10 I_n$ )

\*2: Field fitted

\*3: In case of installing breakers side by side, reduce the passing current to under 80% of the rated current.

\*4: This accessory will be released shortly. Please contact our branch office for release period and more details.

\*5: This standard will be conformed shortly. Please contact our branch office for release period and more details.

## Specifications

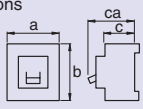
		RCCB			
Model		BVW-T			
Image					
No. of poles [P]		2 (1+N) <sup>*1</sup>		4(3+N) <sup>*1</sup>	
Rated voltage [VAC]		240		415	
Rated current I <sub>n</sub> [A] at ambient temperature 30°C		16, 25, 32, 40, 63		80, 100	
Rated current sensitivity I <sub>Δn</sub> [mA]		30, 100, 300		30, 100, 300	
Max. operating time at 5 I <sub>Δn</sub> [s]		0.04		0.04	
Pulsating current sensitivity		Type AC		Type AC	
Residual operation		Independent of line voltage		Independent of line voltage	
Rated making and breaking capacity I <sub>m</sub> [A]		500(I <sub>n</sub> 16, 25, 32, 40A), 630(I <sub>n</sub> 63A)		800(I <sub>n</sub> 80A), 1000(I <sub>n</sub> 100A)	
Rated conditional short-circuit current I <sub>nc</sub> [kA]		6		10	
Rated residual making and breaking capacity I <sub>Δm</sub> [A]		500(I <sub>n</sub> 16, 25, 32, 40A), 630(I <sub>n</sub> 63A)		800(I <sub>n</sub> 80A), 1000(I <sub>n</sub> 100A)	
Rated conditional residual short-circuit current I <sub>Δc</sub> [kA]		6		10	
Number of operating cycles	Without current	4,000 <sup>*2</sup>		3,000	
	With current	2,000		2,000	
<div>Dimensions [mm]</div> 	a	36	72	36	72
	b	90		90	
	c	44		44	
	ca	74		74	
Mounting		IEC 35mm rail		IEC 35mm rail	
Applicable wire size [mm <sup>2</sup> ]		1 to 25		10 to 35	
Mass [kg]		0.22	0.44	0.22	0.44
Accessories		Not available		Not available	
Terminal connection		Solderless terminal		Solderless terminal	
Based on standard		IEC/EN 61008-1		IEC/EN 61008-1	
CE marking		○		○	

\*1: N pole is a switched neutral pole (without overcurrent release device).

\*2: In case of ampere rating 32, 40 and 63A, the number of operating cycles is 3,000.

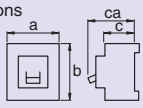
		Isolating Switches													
Model		KBW-T													
Image															
No. of poles [P]		1		2		3		4		2		3		4	
Utilization category		AC-22A								AC-22A					
Rated current $I_n$ [A] at ambient temperature 30°C		25, 40, 63								80, 100, 125					
Rated voltage [VAC]		240		240/415						240/415					
Short time withstand current $I_{cw}$ [A]		12× $I_n$ , 1s								12× $I_n$ , 1s					
Short-circuit making capacity $I_{cm}$ [A]		12× $I_n$								12× $I_n$					
Rated impulse withstand voltage $U_{imp}$ [kV]		6								6					
Pollution degree		2								2					
<div>Dimensions [mm]</div> <div></div>	a	18		36		54		72		36		54		72	
	b	92.6								92.6					
	c	44								44					
	ca	Max. 73.5								Max. 73.5					
Number of operating cycles	Without current	10,000								10,000 8,000(125A)					
	With current	1,500								1,500 1,000(125A)					
Mounting		IEC 35mm rail								IEC 35mm rail					
Applicable wire size [mm <sup>2</sup> ]		1 to 25								10 to 50					
Mass [kg]		0.12		0.22		0.33		0.47		0.20		0.30		0.40	
Accessories		Not available								Not available					
Terminal connection		Solderless terminal								Solderless terminal					
Based on standard		IEC/EN 60947-3								IEC/EN 60947-3					
CE marking		○								○					

# Characteristics and Dimensions

## Miniature Circuit Breakers (MCB)

### BHW-T10 (0.5 to 63A)



Model				BHW-T10											
No. of poles [P]				1	1+N*1	2	3	3+N*1	4	1	1+N*1	2	3	3+N*1	4
Instantaneous tripping				Type B						Type C,D					
Rated insulation voltage $U_i$ [V]				660						660					
Rated current $I_n$ [A] at ambient temperature 30°C				6,10,16,20,25, 32,40,50,63						0.5,1,2,3,4,5, 6,10,16,20,25, 32,40,50,63					
Rated short-circuit capacity [kA]	IEC/EN 60898-1 (Icn)	AC	240V	10						10					
			240/415V	10	—	10		10	—	10					
			415V	—		10		—		10					

\*1: N pole is a switched neutral pole (without overcurrent release device).

### Operating Characteristics

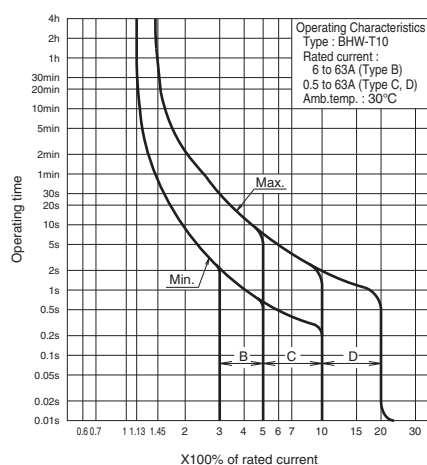

### Outer Dimensions

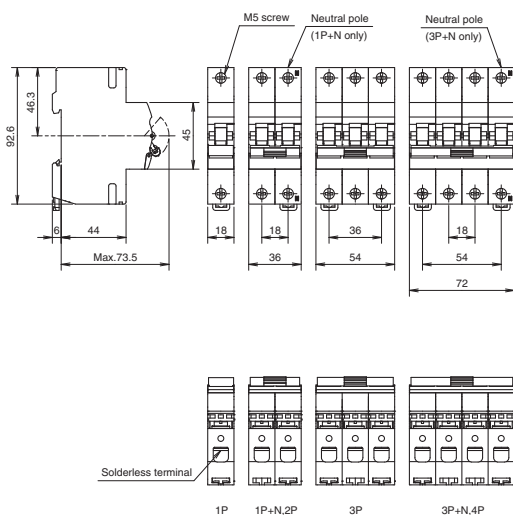

### Ambient Compensation Curve

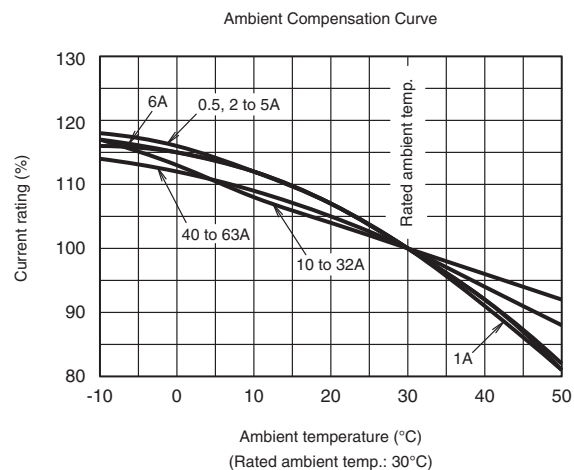

\* In case of installing breakers side by side, reduce the passing current to under 80% of the rated current.



## Accessories

### Functions of Accessories

Accessory	Function
<b>AX</b> Auxiliary switch	Electrically indicates the On/Off status of the circuit breaker.
<b>SHT</b> Shunt trip	Electrically trips the circuit breaker from a remote location. Permissible working voltage is 100% of the rated voltage.

### Specifications

Model	AX
Contact	Configuration
	1A1B
Contact capacity	
220VAC 6A	
Connection	Lead wire



### Specifications

Model	SHT			
Cut-off switch	Equipped			
Voltage	12VDC	24VDC	48VDC	220VAC
Input power requirement [VA]	40	110	300	250
Operating time [ms]	<20			
Connection	Solderless terminal			

\*Secure a sufficient input power supply so that the voltage will not drop below the permissible working voltage (100% of the rated voltage).

\*The operating time denotes the time from when the rated voltage is applied to SHT until the time the main contact of the breaker starts to open.

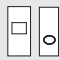
### Combinations of Accessories

Accessory connection combinations	AX	
	SHT	



### Outer Dimensions

BHW-T10 (0.5 to 63A) with AX

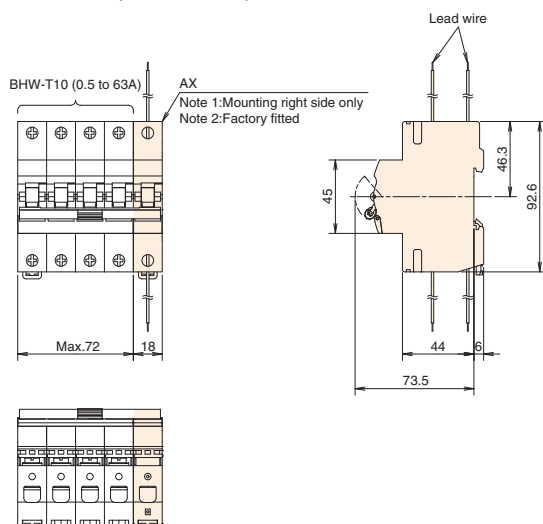

BHW-T10 (0.5 to 63A) with SHT

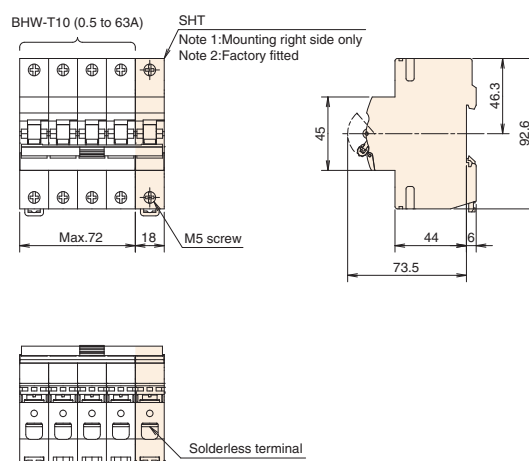

# Characteristics and Dimensions

## Miniature Circuit Breakers (MCB)

### BHW-T10 (80 to 125A)



Model		BHW-T10			
No. of poles [P]		1	2	3	4
Instantaneous tripping		Type B, C			
Rated insulation voltage $U_i$ [V]		690			
Rated current $I_n$ [A]	Amb. temp.	IEC/EN 60898-1*	30°C	80, 100, 125	
		IEC/EN 60947-2	40°C		
Rated short-circuit capacity [kA]		IEC/EN 60898-1* (Icn)	AC 240/415V	10	
		IEC/EN 60947-2 (Icu/Ics)	AC 240/415V	10/7.5	

\* This standard will be conformed shortly. Please contact our branch office for release period and more details.

### Operating Characteristics

IEC/EN60898-1

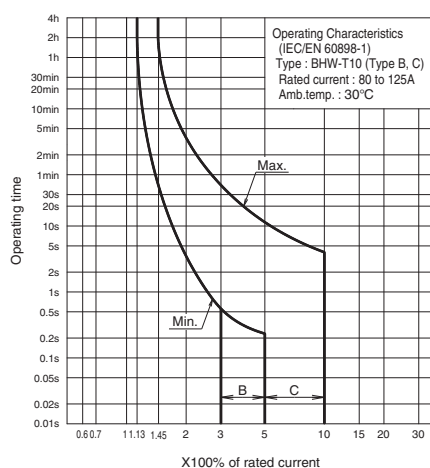

IEC/EN60947-2

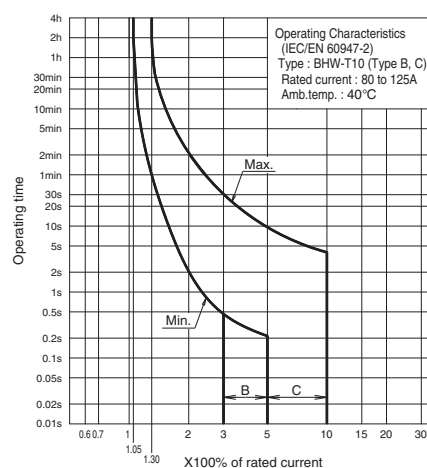

### Outer Dimensions

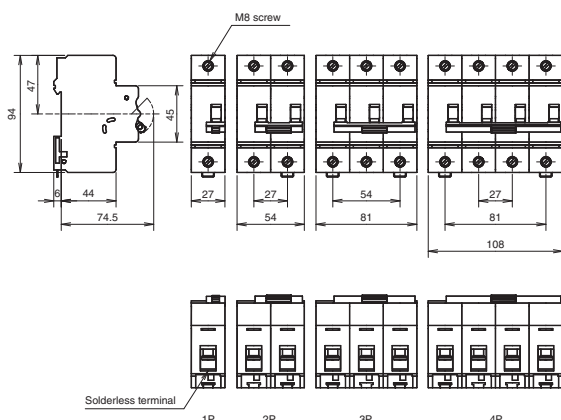

### Ambient Compensation Curve

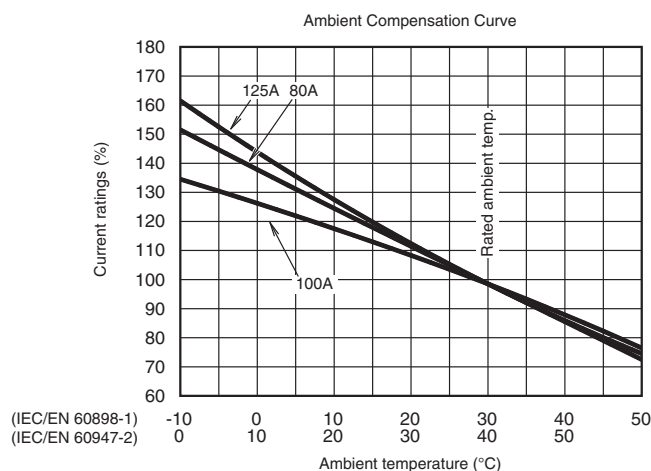

\* In case of installing breakers side by side, reduce the passing current to under 80% of the rated current.

## Accessories

### Functions of Accessories

Accessory	Function
<b>AL</b> Alarm switch <sup>*1</sup>	Electrically indicates the trip status of the circuit breaker.
<b>AX</b> Auxiliary switch	Electrically indicates the On/Off status of the circuit breaker.
<b>SHT</b> Shunt trip <sup>*1</sup>	Electrically trips the circuit breaker from a remote location. Permissible working voltage is 70% of the rated voltage.

### Specifications

Accessory	AL <sup>*1</sup>	AX
Model	AL-1BHW	AX-1BHW
Contact	Configuration	1C
	Contact capacity	230VAC 5A
Connection	Solderless terminal	Solderless terminal

Accessory	SHT <sup>*1*2</sup>	
Model	SHTD024-1BHW	SHTA240-1BHW
Voltage	24VDC	240VAC
Operating time [ms]	<20	
Connection	Solderless terminal	

\*1: This accessory will be released shortly. Please contact our branch office for release period and more details.

\*2: Secure a sufficient input power supply so that the voltage will not drop below the permissible working voltage (70% of the rated voltage).

The operating time denotes the time from when the rated voltage is applied to SHT until the time the main contact of the breaker starts to open.

### Combinations of Accessories

Accessory connection combinations	AL	
	AX	
	SHT	
	AL+SHT	
	AX+SHT	

### Installation of Accessories

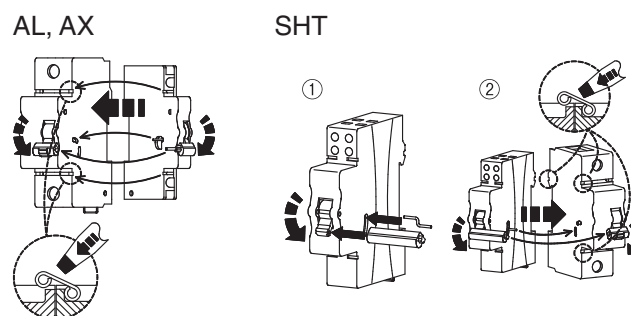

### Outer Dimensions

AL, AX

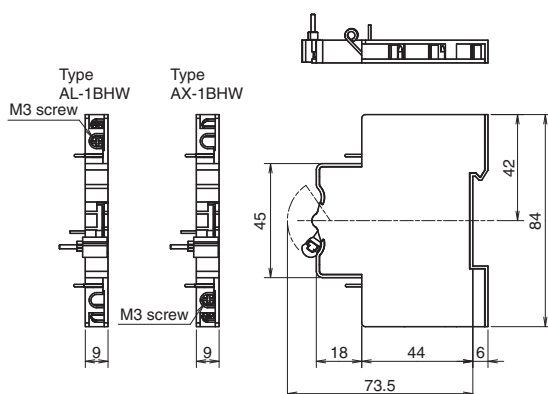

SHT

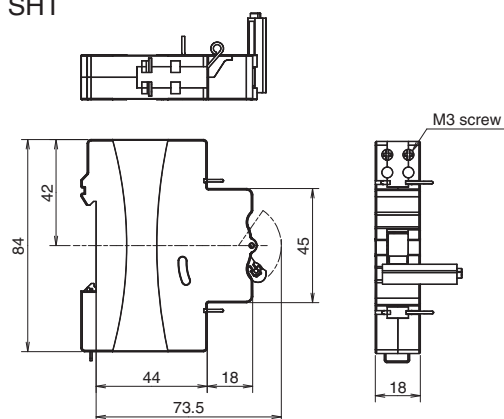

# Characteristics and Dimensions

## Residual Current Circuit Breakers (RCCB)

### BVW-T



Model	BVW-T			
No. of poles [P]	2(1+N) <sup>*1</sup>	4(3+N) <sup>*1</sup>	2(1+N) <sup>*1</sup>	4(3+N) <sup>*1</sup>
Rated voltage [VAC]	240	415	240	415
Rated current $I_n$ [A] at ambient temperature 30°C	16, 25, 32, 40, 63		80, 100	
Rated current sensitivity $I_{\Delta n}$ [mA]	30, 100, 300		30, 100, 300	
Max. operating time at 5 $I_{\Delta n}$ [s]	0.04		0.04	
Pulsating current sensitivity	Type AC		Type AC	
Residual operation	Independent of line voltage		Independent of line voltage	
Rated making and breaking capacity $I_m$ [A]	500(In 16, 25, 32, 40A) 630(In 63A)		800(In 80A) 1000(In 100A)	
Rated conditional short-circuit current $I_{nc}$ [kA]	6		10	
Rated residual making and breaking capacity $I_{\Delta m}$ [A]	500(In 16, 25, 32, 40A) 630(In 63A)		800(In 80A) 1000(In 100A)	
Rated conditional residual short-circuit current $I_{\Delta c}$ [kA]	6		10	

\*1: N pole is a switched neutral pole (without overcurrent release device).

### Earth-Leakage Tripping Characteristics

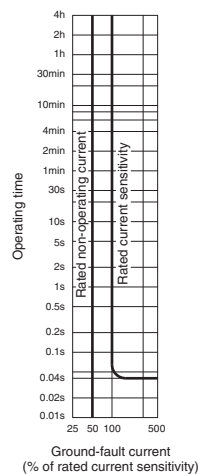

### Outer Dimensions

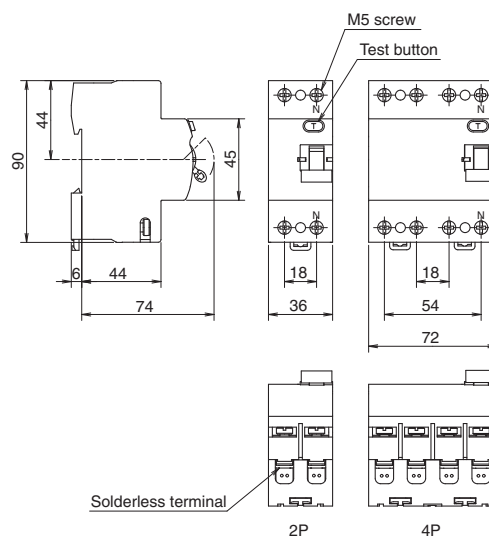



# Characteristics and Dimensions

## Isolating Switches

### KBW-T



Model	KBW-T						
No. of poles [P]	1	2	3	4	2	3	4
Utilization category	AC-22A				AC-22A		
Rated insulation voltage $U_i$ [V]	660				660		
Rated voltage $U_e$ [VAC]	240	240/415			240/415		
Rated current $I_n$ [A] at ambient temperature 30°C	25, 40, 63				80, 100, 125		
Short-time withstand current $I_{cw}$ [A]	12×I <sub>n</sub> , 1s				12×I <sub>n</sub> , 1s		
Short-circuit making capacity $I_{cm}$ [A]	12×I <sub>n</sub>				12×I <sub>n</sub>		

### Outer Dimensions

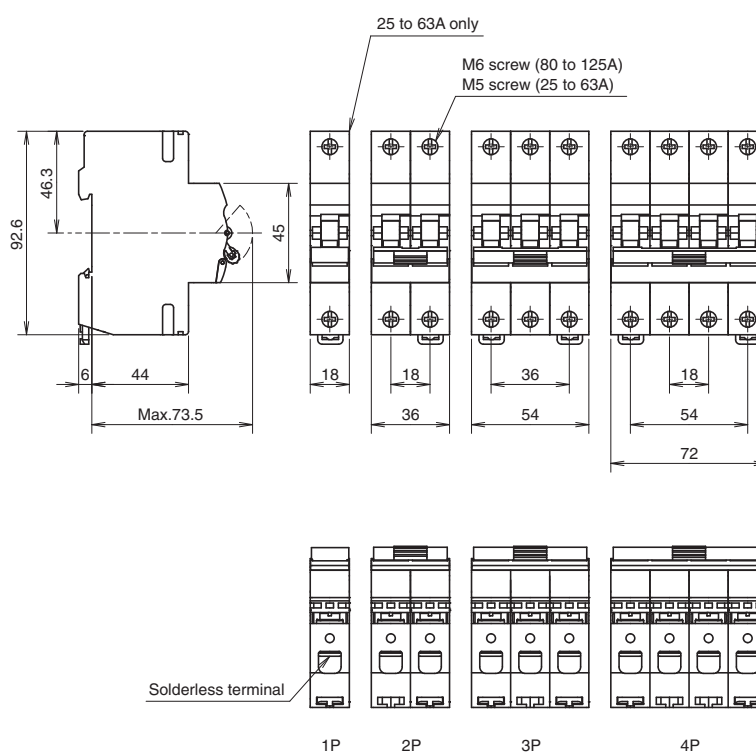

## Ordering Information

### ●MCB

Please specify items with ☐

Model	Number of poles	Operating characteristics	Rated current	Internal accessory	Quantity
BHW-T10	1P	Type C	16A	SHT(12VDC)	12
BHW-T10	1P, 1P+N, 2P, 3P, 3P+N, 4P	Type B Type C Type D	0.5, 1, 2, 3, 4, 5, 6, 10, 16, 20, 25, 32, 40, 50, 63A	SHT(12VDC) SHT(24VDC) SHT(48VDC) SHT(220VAC) AX	Shunt trip Auxiliary switch

Model	Number of poles	Operating characteristics	Rated current	Quantity
BHW-T10	1P	Type C	80A	8
BHW-T10	1P, 2P, 3P, 4P	Type B Type C	80, 100, 125A	

Model	Quantity
AL-1BHW	12
AL-1BHW	Alarm switch
AX-1BHW	Auxiliary switch
SHTD024-1BHW 12VDC	Shunt trip
SHTA240-1BHW 240VAC	

### ●RCCB

Model	Number of poles	Rated current	Rated sensitivity current	Quantity
BVW-T	2P	63A	30mA	5
	2P, 4P	16, 25, 32, 40, 63, 80, 100A	30, 100, 300mA	

### ●Isolating Switches

Model	Number of poles	Rated current	Quantity
KBW-T	1P	63A	12
	1P, 2P, 3P, 4P	25, 40, 63, 80, 100, 125A	

## Information from Fukuyama Works

<http://www.MitsubishiElectric.co.jp/haisei/lvs/>



### Four Key Features

- 1 Product Information
- 2 Downloads
- 3 News
- 4 Support

**MEMO**

# MINIATURE CIRCUIT BREAKERS, RESIDUAL CURRENT CIRCUIT BREAKERS & ISOLATING SWITCHES

## Sales Network

Country / Region	Corporation Name	Address	Telephone
Australia	Mitsubishi Electric Australia Pty. Ltd.	348 Victoria Road, Rydalmere, N.S.W. 2116, Australia	+61-2-9684-7777
Bangladesh	PROGRESSIVE TRADING CORPORATION ELECTRO MECH AUTOMATION& ENGINEERING LTD.	Haque Tower, 2nd floor, 610/11, Jubilee Road, Chittagong, Bangladesh Purana Paltan Lane, (VIP Road), Rokeya Mansion(6th floor), Room#702,Dhaka-1000, Bangladesh	+880-31-624-307 +880-28-321-791
Belarus	Tehnikon	Oktyabrskaya 19, Off. 705, BY-220030 Minsk, Belarus	+375(0)17/210 46 26
Belgium	Koning & Hartman B.V.	Woluwelaan 31, BE-1800 Vilvoorde, Belgium	+32(0)2/2570240
Cambodia	DHINIMEX CO.,LTD	#245, St. Tep Phan, Phnom Penh, Cambodia	+855-23-997-725
Chile	Rhona S.A.	Vie. Agua Santa 4211 Casilla 30-D (P.O. Box) Vina del Mar, Chile	+56-32-2-320-600
China	Mitsubishi Electric Automation (China) Ltd.	Mitsubishi Electric Automation Building, No.1386 Hongqiao Road, Shanghai, 200336	+86-21-2322-3030
	Mitsubishi Electric Automation (China) Ltd. BeiJing Branch	9/F, Office Tower1 Henderson Centre 18 Jianguomennei Dajie DongCheng district Beijing 100005	+86-10-6518-8830
	Mitsubishi Electric Automation (China) Ltd. ShenZhen Branch	Room 2512--2516, Great China International Exchange Square, Jintian Rd.S., Futian District, Shenzhen, 518034	+86-755-2399-8272
	Mitsubishi Electric Automation (China) Ltd. GuangZhou Branch	Room 1609, North Tower, The Hub Center, No.1068, Xing Gang East Road, Haizhu District, Guang Zhou, China 510335	+86-20-8923-6730
	Mitsubishi Electric Automation (China) Ltd. ChengDu Branch	Block B, Room 407-408, Shangri-La Center Office Building, No.9 BinJiang East Road, Chengdu, China 610021	+86-28-8446-8030
	Mitsubishi Electric Automation (Hong Kong) Ltd.	20/F., Cityplaza One, 111 king's Road, Taikoo shing, Hong Kong	+852-2510-0555
Colombia	Proelectrico Representaciones S.A.	Carrera 42 # 75-367 Bod 109 Itagui Colombia	+57-4-4441284
Czech Republic	AUTOCONT CONTROL SYSTEMS S.R.O	Technologická 374/6, CZ-708 00 Ostrava - Pustkovec	+420 595 691 150
Denmark	BEIJER ELECTRONICS A/S	LYKKEGARDSVEJ 17, DK-4000 ROSKILDE	+45(0)46/75 76 66
Egypt	Cairo Electrical Group	9, Rostoum St. Garden City P.O. Box 165-11516 Maglis El-Shaab, Cairo - Egypt	+20-2-27961337
France	Mitsubishi Electric Europe B.V.	25, Boulevard des Bouvets, F-92741 Nanterre Cedex	+33(0)1/55 68 55 68
Germany	Mitsubishi Electric Europe B.V.	Gothaer Str. 8, 40880 Ratingen , Germany	+49(0) 2102 486-0
Greece	KALAMARAKIS - SAPOUNAS S.A.	IONIAS & NEROMILOU STR., CHAMOMILOS ACHARNES, ATHENS, 13678 Greece	+30-2102 406000
	UTECO	5, MAVROGENOUS STR., 18542 PIRAEUS, Greece	+30-211-1206-900
Hungary	Meltrade Ltd.	Fertő utca 14. HU-1107 Budapest, Hungary	+36(0)1-431-9726
India	Mitsubishi Electric India Private Limited	2nd Floor, Tower A&B, Cyber Greens, DLF Cyber City, DLF Phase-III, Gurgaon - 122 022 Haryana, India	+91-124-4630300
Indonesia	P. T. Sahabat Indonesia	P.O.Box 5045 Kawasan Industri Pergudangan, Jakarta, Indonesia	+62-(0)21-6610651-9
Ireland	Mitsubishi Electric Europe B.V.	Westgate Business Park, Ballymount, IRL-Dublin 24, Ireland	+353(0)1-4198800
Israel	Gino Industries Ltd.	26, Ophir Street IL-32235 Haifa, Israel	+972(0)4-867-0656
Italy	Mitsubishi Electric Europe B.V.	Viale Colleoni 7, I-20041 Agrate Brianza (MI), Italy	+39 039-60531
Kazakhstan	Kazpromavtomatika	ul. Zhambyla 28, KAZ - 100017 Karaganda	+7-7212-501000
Korea	Mitsubishi Electric Automation Korea Co., Ltd	9F Gangseo Hangang xi-tower, 401 Yangcheon-ro, Gangseo-gu, Seoul 07528 Korea	+82-2-3660-9572
Laos	AROUNKIT CORPORATION IMPORT-EXPORT SOLE CO.,LTD	SAPHANMO VILLAGE, SAYSETHA DISTRICT, VIENTIANE CAPITAL, LAOS	+856-20-415899
Lebanon	Comptoir d'Electricite Generale-Liban	Cebaco Center - Block A Autostrade Dora, P.O. Box 11-2597 Beirut - Lebanon	+961-1-240445
Lithuania	Rifas UAB	Tinklu 29A, LT-5300 Panevezys, Lithuania	+370(0)45-582-728
Malaysia	Mitric Sdn Bhd	No. 5 Jalan Pemberita U1/49, Temasya Industrial Park, Glenmarie 40150 Shah Alam, Selangor, Malaysia	+603-5569-3748
Malta	ALFATRADE LTD	99 PAOLA HILL, PAOLA PLA 1702, Malta	+356(0)21-697-816
Marocco	SCHIELE MAROC	KM 7,2 NOUVELLE ROUTE DE RABAT AIN SEBAA, 20600 Casablanca, Marocco	+212 661 45 15 96
Myanmar	Peace Myanmar Electric Co.,Ltd.	NO137/139 Botahtaung Pagoda Road, Botahtaung Town Ship 11161, Yangon, Myanmar	+95-(0)1-202589
Nepal	Watt&Volt House	KHA 2-65, Volt House Dillibazar Post Box: 2108, Kathmandu, Nepal	+977-1-4411330
Netherlands	Imtech Marine & Offshore B.V.	Sluisjesdijk 155, NL-3087 AG Rotterdam, Netherlands	+31(0)10-487-19 11
North America	Mitsubishi Electric Automation, Inc.	500 Corporate Woods Parkway, Vernon Hills, IL 60061 USA	+847-478-2100
Norway	Scanelec AS	Leivikasen 43B, NO-5179 Godvik, Norway	+47(0)55-506000
Middle East Arab Countries & Cyprus	Comptoir d'Electricite Generale-International-S.A.L.	Cebaco Center - Block A Autostrade Dora P.O. Box 11-1314 Beirut - Lebanon	+961-1-240430
Pakistan	Prince Electric Co.	2-P, GULBERG II, LAHORE - 54660 PAKISTAN	+92-(0)42-35752323 +92-(0)42-35753373
	AL-KAMAL GROUP	Office No. 7 & 8, 1st Floor, Barkat Ali Khan Center, 101 Circular Road, Lahore. Pakistan	+92-(0)42-37631632
Philippines	Edison Electric Integrated, Inc.	24th Fl. Galleria Corporate Center, Edsa Cr. Ortigas Ave., Quezon City Metro Manila, Philippines	+63-(0)2-634-8691
Poland	Mitsubishi Electric Europe B.V. Polish Branch	Krakowska 50, 32-083 Balice, Poland	+48(0)12 630 47 00
Republic of Moldova	Intehsis SRL	bld. Traian 23/1, MD-2060 Kishinev, Moldova	+373(0)22-66-4242
Romania	Sirius Trading & Services SRL	RO-060841 Bucuresti, Sector 6 Aleea Lacul Morii Nr. 3	+40-(0)21-430-40-06
Russia	Mitsubishi Electric Europe B.V. Moscow Branch	52, bld. 3 Kosmodamianskaya Nab. 115054, Moscow, Russia	+7 495 721-2070
Saudi Arabia	Center of Electrical Goods	Al-Shuwayer St. Side way of Salahuddin Al-Ayoubi St. P.O. Box 15955 Riyadh 11454 - Saudi Arabia	+966-1-4770149
Singapore	Mitsubishi Electric Asia Pte. Ltd.	307 Alexandra Road, Mitsubishi Electric Building, Singapore 159943	+65-6473-2308
Slovakia	PROCONT, Presov	Kupelna 1/, SK - 08001 Presov, Slovakia	+421(0)51-7580 611
	SIMAP	Jana Derku 1671, SK - 91101 Trencin, Slovakia	+ 421(0)32 743 04 72
Slovenia	Inea RBT d.o.o.	Stegne 11, SI-1000 Ljubljana, Slovenia	+386(0)1-513-8116
South Africa	CBI-electric: low voltage	Private Bag 2016, ZA-1600 Isando Gauteng, South Africa	+27-(0)11-9282000
Spain	Mitsubishi Electric Europe B.V. Spanish Branch	Carretera de Rubi 76-80, E-08190 Sant Cugat del Vallés (Barcelona), Spain	+34(0)93-565-3131
Sweden	Euro Energy Components AB	Järnvägsgatan 36, S-434 24 Kungsbacka, Sweden	+46(0)300-690040
Switzerland	TriElec AG	Muehentalstrasse 136, CH-8201 Schaffhausen	+41-(0)52-6258425
Taiwan	Setsuyo Enterprise Co., Ltd	5th Fl., No.105, Wu Kung 3rd, Wu-Ku Hsiang, Taipei, Taiwan, R.O.C.	+886-(0)2-2298-8889
Thailand	United Trading & Import Co., Ltd.	77/12 Bamrungmuang Road, Klong Mahanak Pomprab Bangkok Thailand	+66-223-4220-3
Tunisia	MOTRA Electric	3, Résidence Imen, Avenue des Martyrs Mourouj III, 2074 - El Mourouj III Ben Arous, Tunisia	+216-71 474 599
Turkey	GTS	Bayraktar Bulvarı Nutuk Sok. No:5, Posta Kutusu34384, TR-34775 Yukarı Dudulla-Uemraniye, Istanbul, Turkey	+90(0)216 526 3990
United Kingdom	Mitsubishi Electric Europe B.V.	Travellers Lane, UK-Hatfield, Herts. AL10 8XB, United Kingdom	+44(0)1707-276100
Uruguay	Fierro Vignoli S.A.	Avda. Uruguay 1274 Montevideo Uruguay	+598-2-902-0808
Venezuela	Adesco S.A.	Calle 7 La Urbina Edificio Los Robles Locales C y D Planta Baja, Caracas - Venezuela	+58-212-241-9952
Vietnam	Mitsubishi Electric Vietnam Co., Ltd. Head Office	Unit01-04, 10th Floor, Vincom Center, 72 Le Thanh Ton Street, District 1, Ho Chi Minh City, Vietnam	+84-8-3910-5945
	Mitsubishi Electric Vietnam Co., Ltd. Hanoi Branch	6th Floor, Detch Tower, 8 Ton That Thuyet Street, My Dinh 2 Ward, Nam Tu Liem District, Hanoi City, Vietnam	+84-4-3937-8075

**For Safety :** Please read the instruction manual carefully before using the products in this catalog.

Wiring and connection must be done by the person having a specialized knowledge of electric construction and wiring.



for a greener tomorrow

Eco Changes is the Mitsubishi Electric Group's environmental statement, and expresses the Group's stance on environmental management. Through a wide range of businesses, we are helping contribute to the realization of a sustainable society.



## MITSUBISHI ELECTRIC CORPORATION

HEAD OFFICE: TOKYO BUILDING, 2-7-3, MARUNOUCHI, CHIYODA-KU, TOKYO 100-8310, JAPAN